

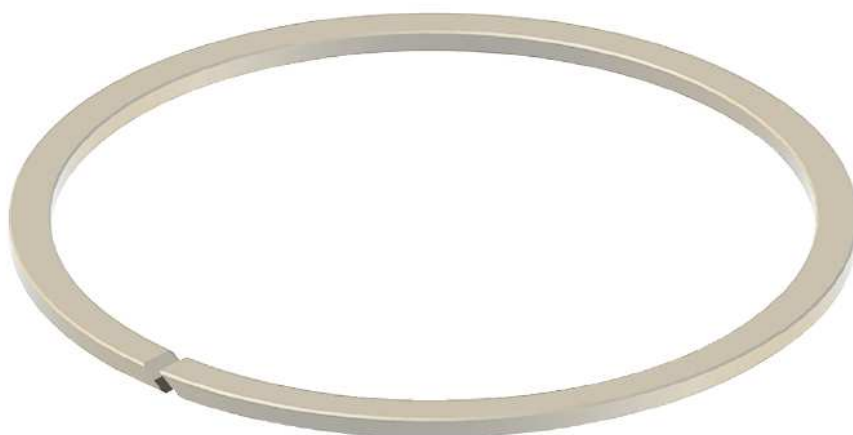

## **WILLIAM JOHNSTON** & COMPANY LIMITED

Glasgow Tel: +44 (0) 141 620 1666 | Inverness Tel: +44 (0) 1463 238 673  
[sales@williamjohnston.co.uk](mailto:sales@williamjohnston.co.uk) | [www.williamjohnston.co.uk](http://www.williamjohnston.co.uk)

### **BACK-UP RINGS**



Back up Rings or anti extrusion rings as they are sometimes called have been used for many years in conjunction with O-Rings in high pressure applications. In general terms for dynamic applications over 100 bar, and static applications around 950 Bar back up rings should be used. Each application can vary so you must check and use this as a general guideline only. Traditionally PTFE has been used for these items but in recent years contoured elastomers rings have been developed and are now quite widely used.

Various alternative styles are available. Please consult with our technical team who will be pleased to advise you.

MATERIALS		TEMPERATURE RANGE	°C
NITRILE		-40	120
VITON®/FLOUROCARBON		-26	204
PTFE		-268	232
PEEK		-70	260
HYTREL®		-54	149
URETHANE		-54	105



**SOLID FLAT**



**SCARF CUT**



**SPIRAL CUT**



**SOLID CONTOURED**



**BUTT CUT**